

Product Details

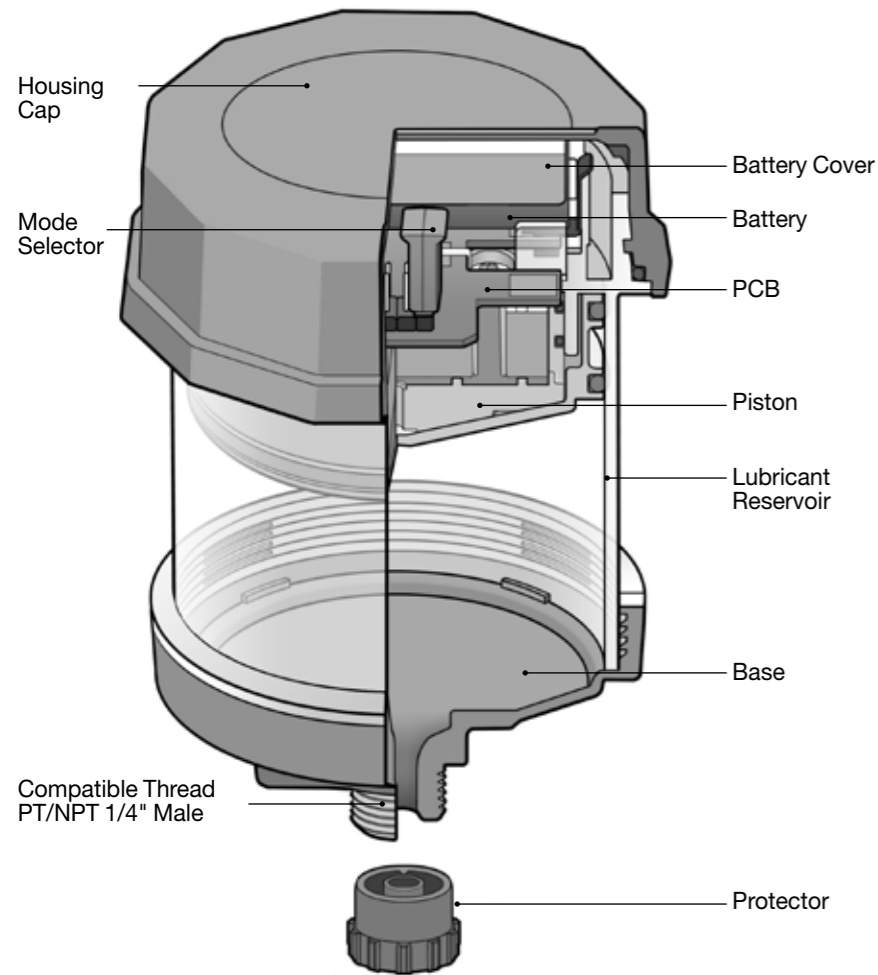

Installation/Disposal Guidelines

*All parts should be assembled tightly with PTFE tape.

Mounting Installations

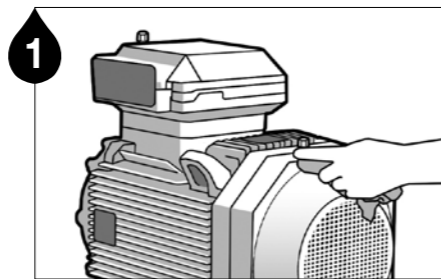

1 Remove contaminants around the lube point.

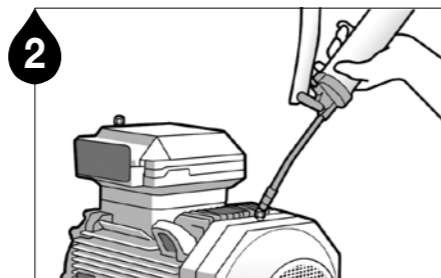

2 Ensure a clear passage using a manual grease gun. **Note 1** Remove any hardened grease by purging the lube point with a manual grease gun. **Note 2** The grease in the equipment and the grease contained in the unit must be the same or compatible.

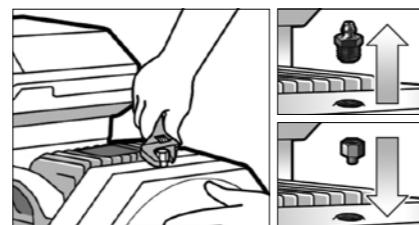

5 Remove the grease nipple and install appropriate adaptors.

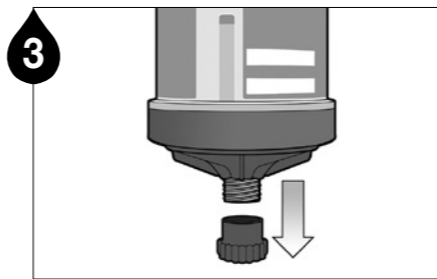

3 Remove the protector.

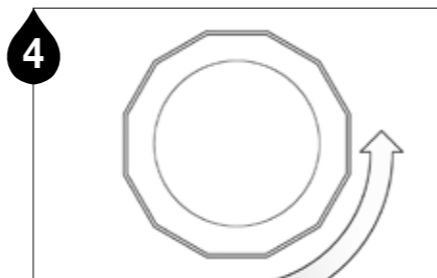

4 Turn the housing cap counterclockwise and unscrew the cap.

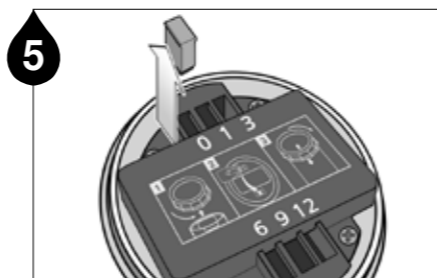

5 Pull out the yellow Mode Selector from the default OFF position.

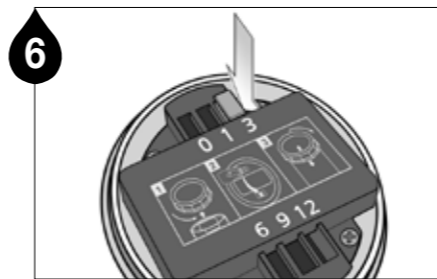

6 Firmly push the Mode Selector into the slot of the desired dispensing period.

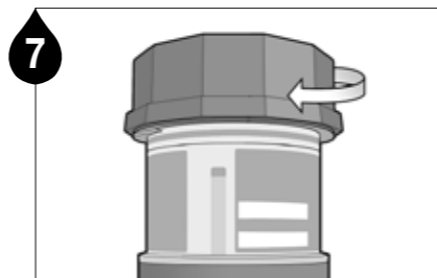

7 Screw the housing cap back onto the body.

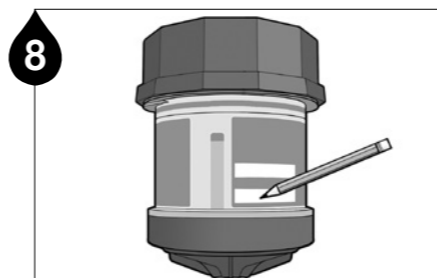

8 Note the installation date and the scheduled date of lube cycle completion on the label of the Pulsarlube E. **Note** Please note there is a delay before the actual dispensing starts. It may take up to 1-3 weeks for enough gas to be formed depending on the dispensing setting & installation condition.

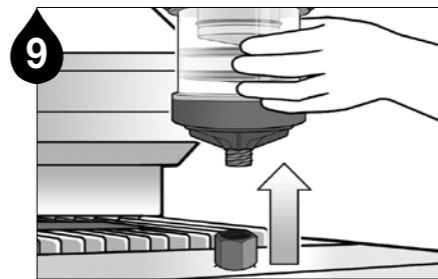

9 When the selected dispensing period of the Pulsarlube E has completed, remove the lubricator from the application.

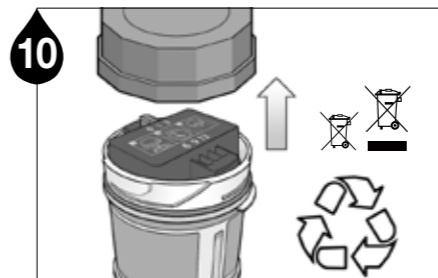

10 The Pulsarlube E is an eco-friendly product that can be broken down and disposed of separately. Turn the housing cap counterclockwise to disassemble the product for proper disposal.

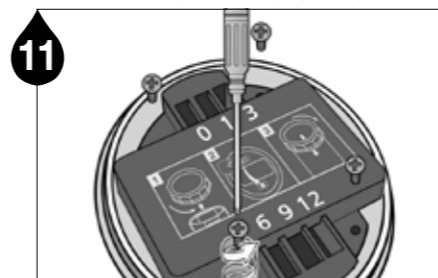

11 Unscrew the screws to remove the battery cover.

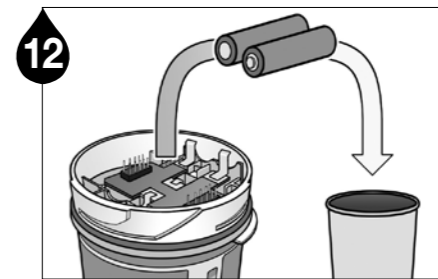

12 Remove the batteries.

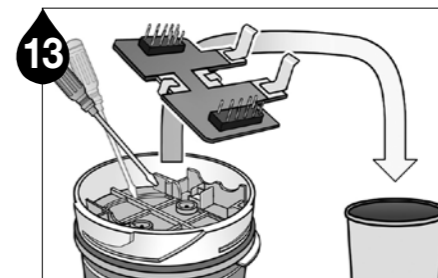

13 Using a hand tool such as a flat-head screwdriver, detach the PCB from the unit.

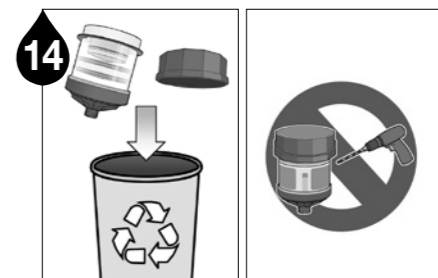

14 Dispose of remaining plastic components complying with local regulations for recycling or waste. **Warning** Do not cut, puncture, or reuse lubricator.

High backpressure can cause a delay in dispensing (must be under 5bar).

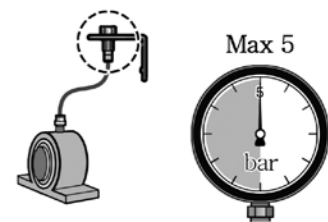

If the product is installed at a 45° or 90° angle, please use an angle adapter with a diameter greater than or equal to 1/4".

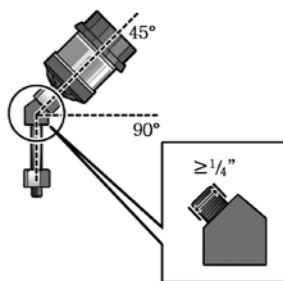

For remote installation using an Ø8 tube, keep the maximum distance at 1m (3ft) or less.

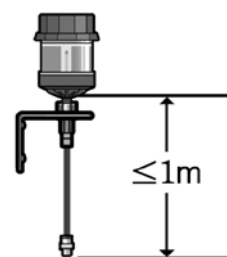

How to Order

EX) E120 / PL1

Product Name	Capacity	Grease Type
E	120	PL1

Pulsarlube E Standard Lubricants

Grease	Grease Type
PL1	Multi Purpose
PL2	Heavy Duty
PL3	High Speed
PL4	H1 Food Grade
PL5	High Temperature
*PL6	*Multi Purpose with MoS ₂
PL7	Low Temperature
PL10	Electric Motor Bearing

*Asia Pacific (Asia, Oceania, Africa) Only

Note OEM filling is available upon request under special terms and conditions. Please contact your local distributor for more information.

Dispensing Volume Chart

Dispensing Period	Dispensing Volume		
	60ml	120ml	240ml
1 month	2.00ml/day	4.00ml/day	8.00ml/day
3 month	0.67ml/day	1.33ml/day	2.66ml/day
6 month	0.33ml/day	0.67ml/day	1.33ml/day
9 month	0.22ml/day	0.44ml/day	0.89ml/day
12 month	0.17ml/day	0.33ml/day	0.67ml/day

Note Dispensing volumes (ml/day) are calculated assuming the lubricator is operating at 1 atm (14.7psi), 20°C (70°F). Output volume may vary with ambient temperature changes, atmospheric pressure changes, consistency of lubricant, or any resistance or backpressure existing at the lube point (bearing or passage).

Warning This product is a disposable unit. Please replace with a new unit once set dispensing period has completed.

Product Certifications

Certifications		
IECEX	Ex ia IIC T4 Ga IECEX KTL 12.0008X -20°C ≤ Ta ≤ +55°C	IEC 60079-0 : 2017 IEC 60079-11 : 2011
ATEX	II 1 G Ex ia IIC T4 Ga INERIS 12ATEX0062X -20°C ≤ Ta ≤ +55°C	CE 0344 EN IEC 60079-0 : 2018 EN 60079-11 : 2012
KCs	Ex ia IIC T4 Ga 12-KB2BO-0283X -20°C ≤ Ta ≤ +55°C	
UL	UL US LISTED E352761	CL I, Div. 1, Gps. A, B, C, D CL II, Div. 1, Gps. E, F, G Hazardous locations, intrinsically safe, Exia, Temp. Code T4, -25°C ≤ Ta ≤ +55°C

MSHA Approval No. 18-A180003-0
TESTED FOR INTRINSIC SAFETY IN METHANE
-AIR MIXTURES ONLY

IP code IP68

Warning

- ▶ Locations : Intrinsically Safe, SÉCURITÉ INTRINSÈQUE, Exia
- ▶ Potential electrostatic charging hazard ; clean only with a damp cloth
- ▶ The user will have to perform an electrostatic risk assessment in order to meet the requirements of the IEC / TS 60079-32-1 guide.
- ▶ Substitution of components may impair Intrinsic Safety :
AVERTISSEMENT : LA SUBSTITUTION DE COMPOSANTS PEUT COMPROMETTRE LA SÉCURITÉ INTRINSÈQUE
- ▶ Do not change, replace, or charge battery cells
- ▶ Temp Code T4 : -25°C ≤ TA ≤ +55°C
- ▶ If ignitable gasses are present, touch only with an insulating object or while wearing an electrostatic grounding device
- ▶ To prevent ignition of flammable or combustible atmospheres, read, understand, and adhere to manufacturer's live maintenance procedure
- ▶ The batteries are not user-replaceable

Mounting Methods

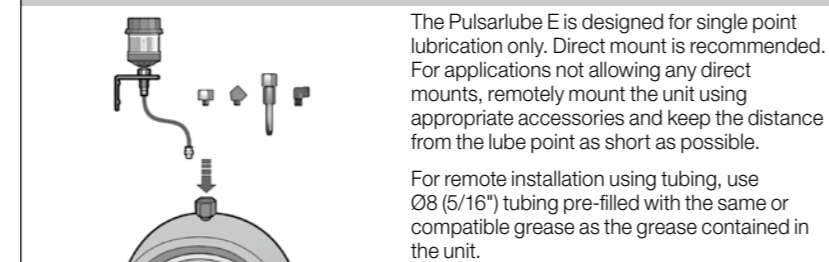

The Pulsarlube E is designed for single point lubrication only. Direct mount is recommended. For applications not allowing any direct mounts, remotely mount the unit using appropriate accessories and keep the distance from the lube point as short as possible.

For remote installation using tubing, use Ø8 (5/16") tubing pre-filled with the same or compatible grease as the grease contained in the unit.

Warning

- ▶ Due to the low output pressure of gas type lubricators, discharge may be delayed during remote installation, in cold temperatures, or when selecting an extended dispensing period.
- ▶ If the differential pressure exceeds the specified limit, grease may extrude from the joints or seams of the base.

Shelf life and Product Warranty The shelf life of the Pulsarlube E unit is 1 year from the date of production. Product warranty is limited to original defects in material and workmanship and will not cover any collateral damage due to mishandling, abuse and/or any other inappropriate use of this product. Warranty period is 1 year from the date of purchase.

PULSARLUBE

The World Leader of Automatic Lubrication

Pulsarlube USA, Inc.

1170 Ardmore Ave Itasca IL 60143, USA
TEL : 1-847-593-5300 / FAX : 1-847-593-5303
www.pulsarlube.com / info@pulsarlube.com

Manufacturer : KLT Co., Ltd.

34-12, Bangchon-ro 955beon-gil, Tanhyeon-myeon,
Paju-si, Gyeonggi-do, Korea

