

Product Details

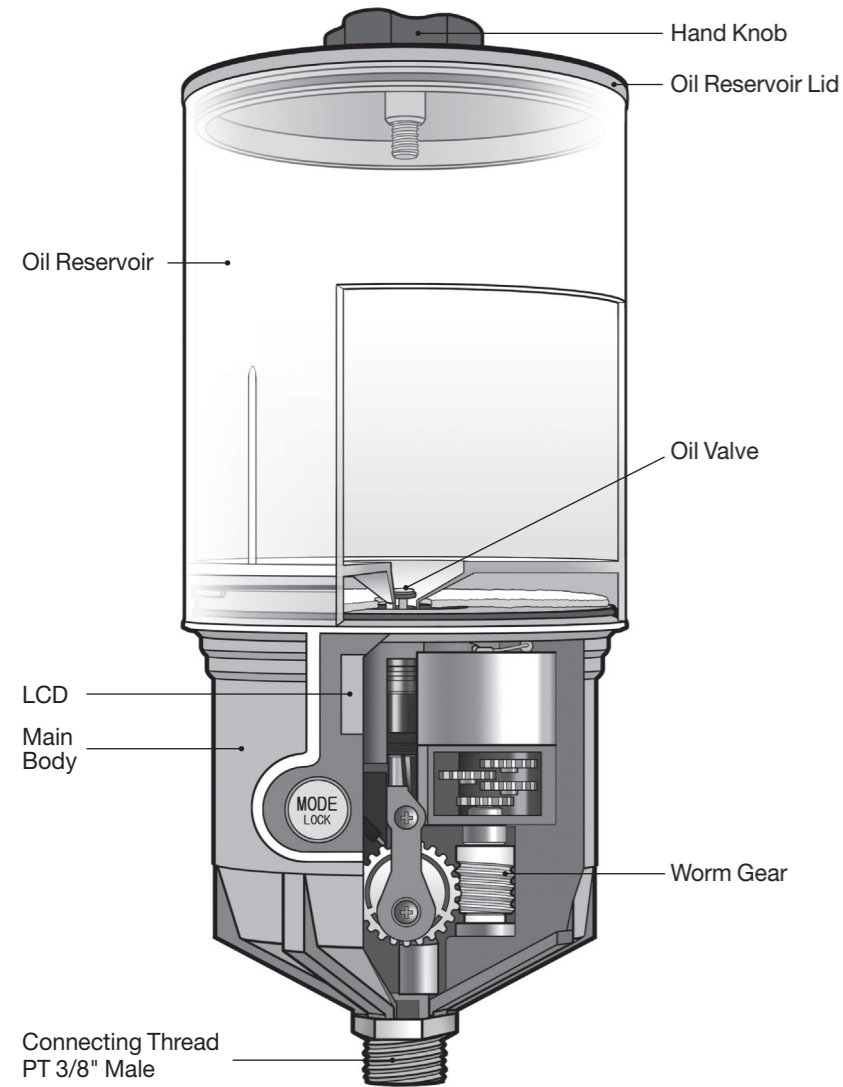

Installation Guidelines

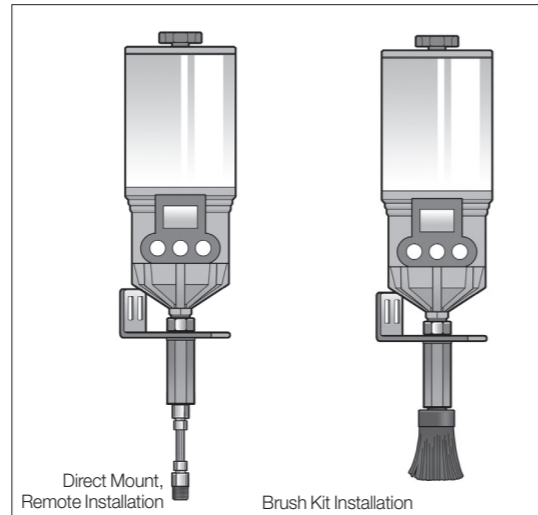

A. Single Point Installation using Brush Kit

Install appropriate accessories and brush kits.

Note

For a complete list of available accessories, refer to the list on the back labeled Accessories for Oil Lubrication.

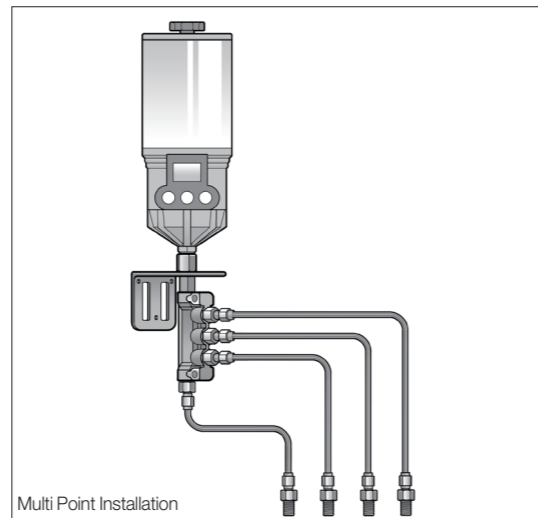

B. Multi Point Installation using Multi Point Installation Kit

Available up to 4 points using oil distributor. (Select the appropriate 1250RO multi-point kit)

Note

Mount the Pulsarlub OL500 unit in close proximity to the application to keep feed lines as short as possible.

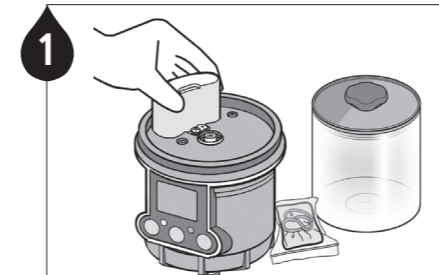

Remove the oil reservoir and check that the battery is properly installed.

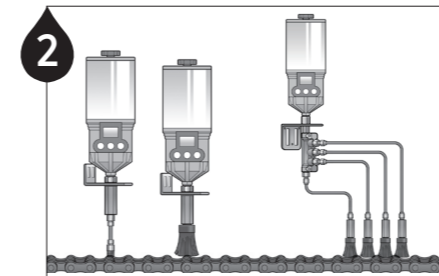

Install the appropriate accessories for the selected installation method. Refer to the user manual included with your single/multi point installation kit or brush and bracket kit.

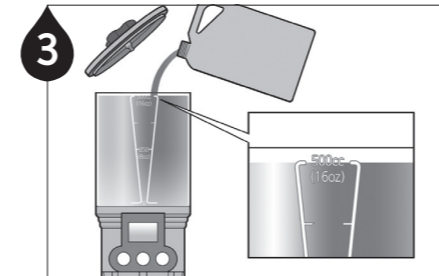

Remove the oil reservoir lid and fill the reservoir with oil to the 500ml level.

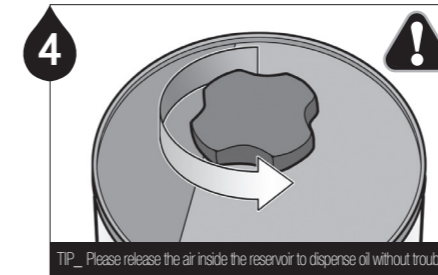

TIP: Please release the air inside the reservoir to dispense oil without trouble.

Turn the hand knob counter clockwise 1~2 turns before closing the lid to open the vent and relieve vacuum pressure.

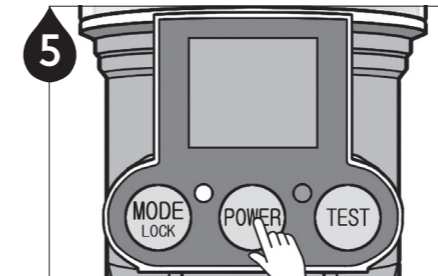

Press the POWER button for 2 seconds to turn on the unit.

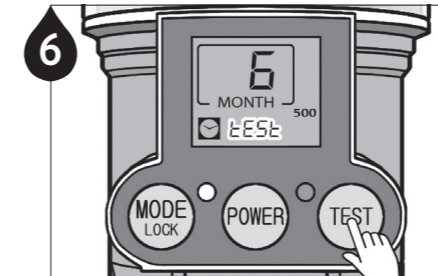

Press the TEST button for 2 seconds to run a test cycle and check for proper operation of the unit. Oil will dispense during the test cycle.

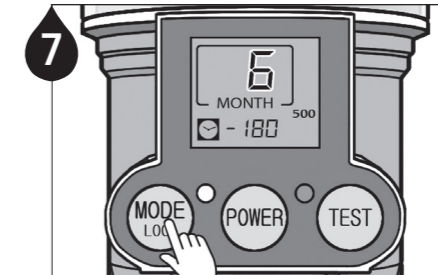

Press the MODE button to program the dispensing period.

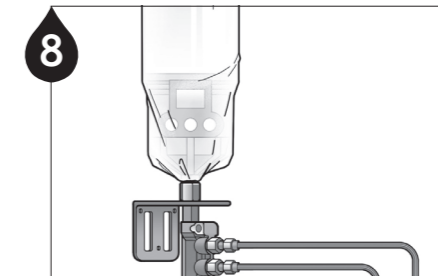

Use the included transparent dust cover to protect the unit from contamination.

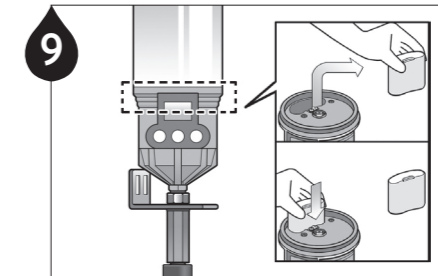

The Pulsarlub OL500 is a reusable unit but the battery pack must be replaced when each dispensing period set is complete. After installing a new battery, reset the unit and repeat the previous steps.

Troubleshooting Guidelines

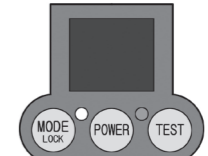

Symptom : Blank LCD screen
Possible Cause : Electrical malfunction of CPU or circuitry, battery problem
Solution : Replace battery pack or press reset button to restart the lubricator. If the problem persists, contact your supplier.

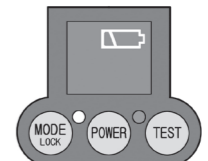

Symptom : Low Battery Indication
Possible Cause : Rapid power consumption due to improper storage or harsh operating conditions (temperature, humidity, or high backpressure).
Solution : Store the battery pack in cool, dry place and choose proper battery type for application. Optional lithium battery pack is available for more advanced applications.

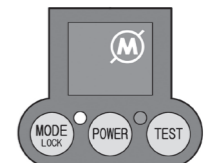

Symptom : Excessive Backpressure Indication
Possible Cause : Excessive backpressure due to over-oil lubrication, ruptured lube line, long distance remote installation, etc.
Solution : A) Check backpressure at lube point and/or lube line, B) check oil dispensing rate, C) reduce remote installation distance.

Button Operation

MODE LOCK
Dispensing Period
 Press to set dispensing period
 1, 2, 4, 6, 12, 18, 24 month & 15 days (H)

POWER
 Power **ON/OFF**
 Press to Power unit On or Off

TEST
TEST Mode
 ON : Press for 2 seconds
 OFF : Short press of button
 (will stop after completion of ongoing cycle)

RESET
 Reset to default setting when the unit malfunctions and/or after changing the Service Pack

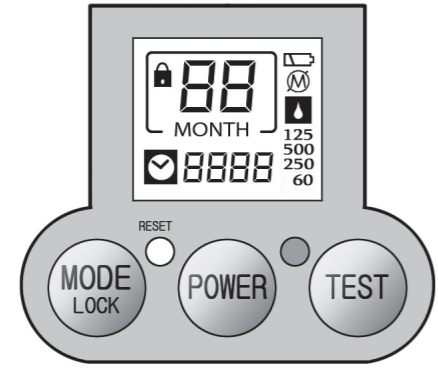

LCD Display

6
 MONTH
 Dispensing period setting

CH03
 Number of days operation has been on hold due to excessive backpressure

- 180
 Remaining dispensing days

Low battery power

Automatic Lock Out mode

Operation on hold due to excessive backpressure

500
 Oil reservoir capacity

Empty oil level

TEST
 TEST mode

LED blinks when battery is low, excessive backpressure exists, or oil level is empty

5t03 Number of days since the cycle ended (and will also display)

ISO9001/14001

Kit Part Number Guide (Sold Separately)

Oil lubrication kit (Kit No.)

Installation Kit Type	EO Gas Type Oiler Part No.	OL Mechanical Type Oiler Part No.
Remote Mount	2000RO-1	1250RO-1
Multi-Point Installation	N/A	1250RO-2~4
Brush Kit	C038, C039, C040, C041	C032, C033, C044, C045
Brush Remote Installation	C042, C043	C046, C047

- Note**
1. Use OEM Pulsarlube oil kits to ensure proper lubrication
 2. To download installation manuals, please visit our website at www.pulsarlube.com.
 → Products Pulsarlube Installation Kits → Oil Lubrication
 3. Do not use Teflon tape on parts connected to oil distributor (Item no. C003-1~C003-3)

Warning

For oils below ISO VG 100, place the oilers below the lube points and curl the lube lines a couple of times to avoid oil leaks caused by gravity.
 For oils below ISO VG 100 – OL500 products should be installed below the lube points.

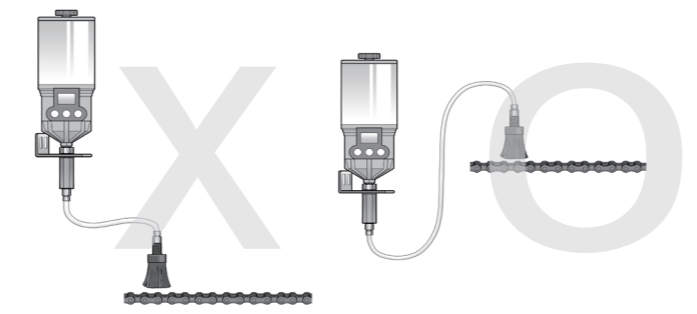

Shelf life and Product Warranty Warranty is limited to original defects in material and workmanship and will not cover any collateral damage due to mishandling, abuse and /or any other inappropriate use of this product. Warranty period is 1year from the date of purchase.

Rev.02

PULSARLUBE
 The World Leader of Automatic Lubrication

Pulsarlube USA, Inc.
 1170 Ardmore Ave Itasca IL 60143, USA
 TEL:1-847-593-5300 FAX:1-847-593-5303 www.pulsarlube.com / info@pulsarlube.com

PULSARLUBE

User Manual

Pulsarlube
OL500
 (500ml)